

TOP VIEW

1-1/4" X 1-1/4" X 1/8" X 13"
ALUMINUM WALL BRACKET
(PLBRACKET-AL STD) X1

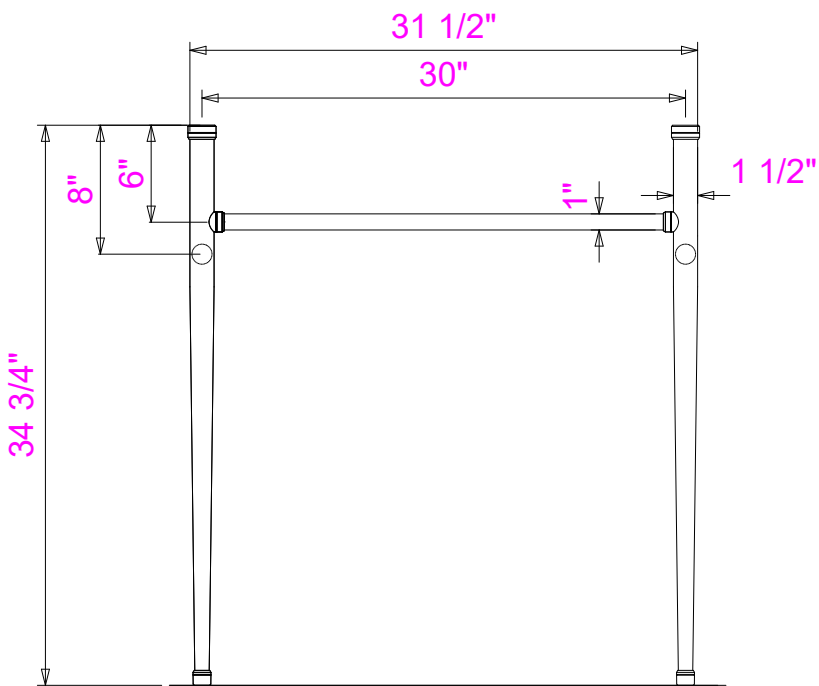

FRONT VIEW

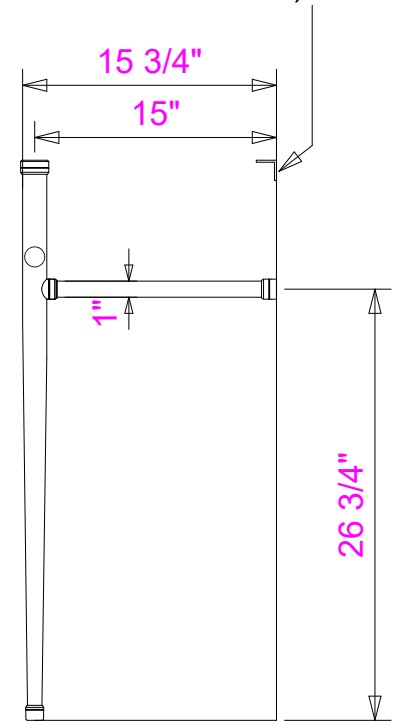

SIDE VIEW

REV				CHANGE(S)		BY	DATE
REMARKS				DRAWER	JB	1-18-13	DESCRIPTION(S)
PALMER LS2MSFCR MINIMAL LEG SYSTEM FOR STONE FOREST CORTINA C98-36				MATERIAL	BRASS		PALMER INDUSTRIES
				FINISH			379 Charles Street Providence, RI 02904 Phone: 800-398-9676 Fax: 401-421-4238 email: jamie@sinklegs.com
				PL-0072			PART NUMBER(S)
						LS2MSFCR	

These designs and drawings are confidential, and the exclusive property of Palmer Industries. They may not be disclosed or duplicated without the expressed, written consent of Palmer Industries. Copyright circa 2012 Palmer Industries. All rights reserved.