

KENSINGTON
2-Way Diverter
MODEL # 19271VP0

Pure Freude
an Wasser

GROHE

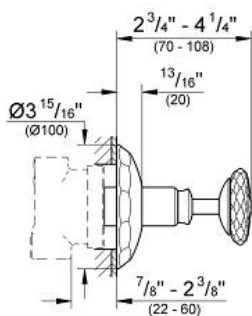

Product Description:
KENSINGTON
2-Way Diverter

Standard Specification:

- For use with Diverter Rough-In Valve (29 712)
- Escutcheon with wall sealing
- Threaded
- Adjustable installation depth
- **GROHE StarLight** chrome finish

Applicable Codes & Standards:

- Energy Policy Act of 1992
- ASME A112.18.1/CSA B125.1

Color:

□ 19271VP0