









CYO Three-hole lavatory mixer with drain - Chrome

20 713 811



- 6-5/8" Projection
- US drain with overflow
- Rigid spout
- Rectangular aerated stream
- Total height 7-3/4"
- Height to aerator/spout outlet 5-1/4"
- Spout hole diameter 1-3/8"
- Valve hole diameter 1-1/4"
- Handle Ø 2-3/8"
- Water flow rate limited to max. 1.2 gpm
- lead-free
- This product can help a building meet the requirements of Green Building Rating Systems, e.g. LEED®, BREEAM®, DGNB

NOTE: Handle inserts are sold separately!

	Chrome	20 713 811-00 0010
	Brushed Platinum	20 713 811-06 0010
	Dark Chrome	20 713 811-19 0010
	Brushed Durabronze (23kt Gold)	20 713 811-28 0010
	Platinum / Brushed Platinum	20 713 811-36 0010
	Durabronze / Brushed Durabronze (23kt Gold)	20 713 811-38 0010
	Brushed Dark Platinum	20 713 811-99 0010



CYO Three-hole lavatory mixer with drain - Chrome

20 713 811

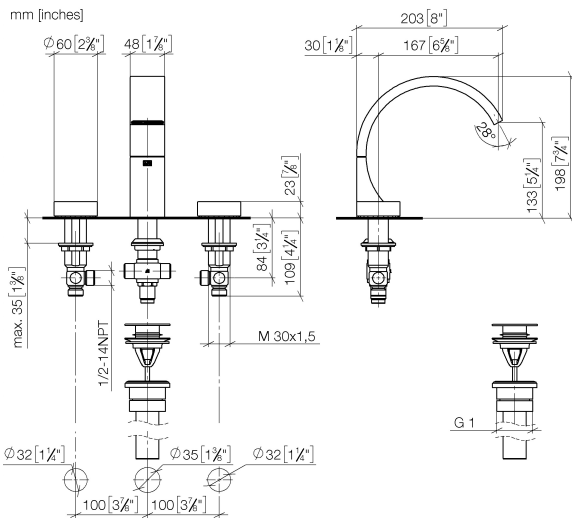

Flow rate chart

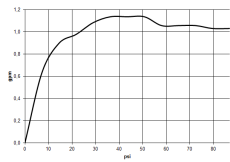

Codes & Standards

ASME A112.18.1	California Energy Commission (CEC)	cUPC	EPA WaterSense
NSF372	NSF61	Water Sense	WaterSense

