

## Rain shower with ceiling fixing 300 x 240 mm - Chrome

SERIES SPECIFIC

28 775 980 Product version from 3/13/2017



- PURE RAIN, max. flow rate 6.8 l/min (at 3 bar)
- with anti-scale system
- rain shower 300 x 240mm
- distance between ceiling and lower edge of the shower 165mm
- rosette 60 x 60, as required
- 1/2" connection
- Function from: 6 l/min
- This product reduces water consumption by 28% (compared to requirements of EPAAct '92)
- This product can contribute to Water Use Reduction in LEED® Green Building Rating
- This product can help a building meet the requirements of Green Building Rating Systems, e.g. LEED®, BREEAM®, DGNB

	Chrome	28 775 980-00 0010
	Brushed Platinum	28 775 980-06 0010
	Platinum	28 775 980-08 0010
	Dark Chrome	28 775 980-19 0010
	Brushed Light Gold	28 775 980-27 0010
	Brushed Durabronze (23kt Gold)	28 775 980-28 0010
	Matte Black	28 775 980-33 0010
	Brushed Bronze	28 775 980-42 0010
	Brushed Champagne (22kt Gold)	28 775 980-46 0010
	Champagne (22kt Gold)	28 775 980-47 0010
	Brushed Chrome	28 775 980-93 0010
	Brushed Dark Platinum	28 775 980-99 0010

### Required miscellaneous



- Concealed wall elbow -** 35 085 970-90  
 •min. recess depth 90 mm 0010  
 •max. recess depth 163 mm

28 775 980 Product version from 3/13/2017

mm [inches]

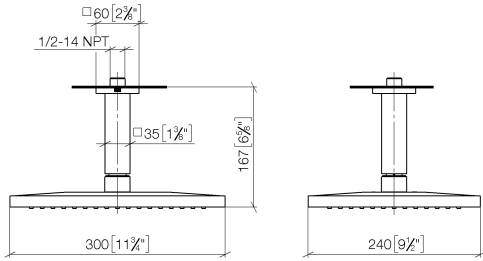

**Codes & Standards**

ASME A112.18.1	California Energy Commission (CEC)	cUPC	EPA WaterSense
----------------	------------------------------------	------	----------------

WaterSense



**Certificates and sustainability**

IAPMO_4976	IAPMO_11777
------------	-------------

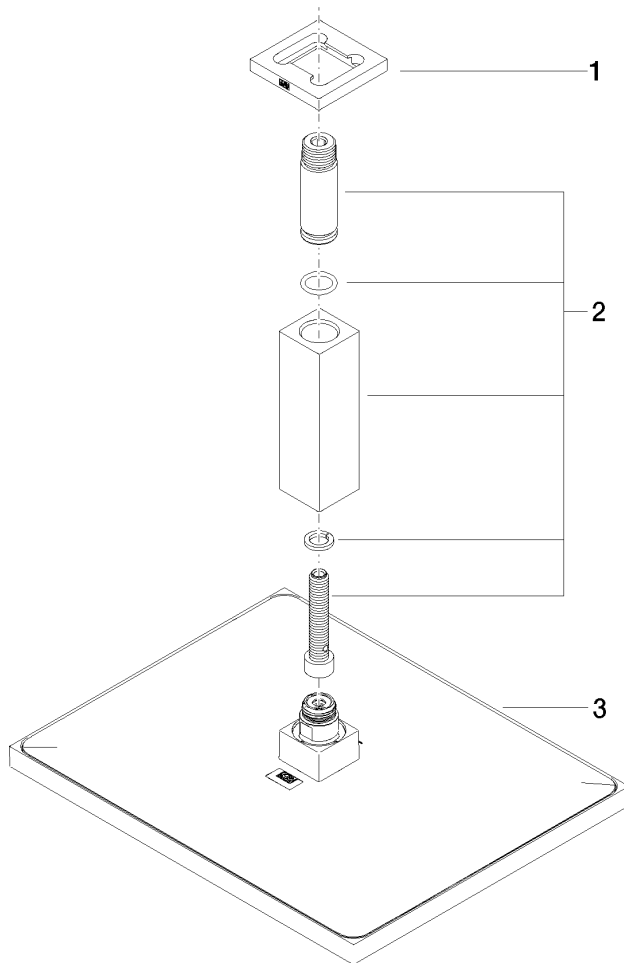

### Spare parts list

No.	Item Number	Name	Quantity used	Delivery time
2	90 11 10 092 00-00	Connection vertical for spray ceiling fixing 35 x 35 x 135 mm - Chrome	1.00	10
1	09 27 98 017-00	Rosette for rain shower Ceiling mounting 60 x 9 x 60 mm - Chrome	1.00	10
3	04 12 05 063 10-00	Rain shower angular 300 x 240 mm - Chrome	1.00	20