















Rain shower with wall fixing 300 mm - Brushed Champagne (22kt Gold)

SERIES SPECIFIC

28 679 970 Product version from 3/13/2017



- 450mm projection
- PURE RAIN, max. flow rate 6.8 l/min (at 3 bar)
- Function from: 6.5 l/min
- with anti-scale system
- rain shower Ø 300 mm
- rosette Ø 60 mm
- 1/2" connection
- quick clearing
- This product reduces water consumption by 28% (compared to requirements of EAct '92)
- This product can contribute to Water Use Reduction in LEED® Green Building Rating
- This product can help a building meet the requirements of Green Building Rating Systems, e.g. LEED®, BREEAM®, DGNB

	Brushed Champagne (22kt Gold)	28 679 970-46 0010
	Chrome	28 679 970-00 0010
	Brushed Platinum	28 679 970-06 0010
	Platinum	28 679 970-08 0010
	Dark Chrome	28 679 970-19 0010
	Light Gold	28 679 970-26 0010
	Brushed Light Gold	28 679 970-27 0010
	Brushed Durabrass (23kt Gold)	28 679 970-28 0010
	Matte Black	28 679 970-33 0010
	Brushed Dark Brass	28 679 970-39 0010
	Brushed Bronze	28 679 970-42 0010
	Champagne (22kt Gold)	28 679 970-47 0010
	Brushed Chrome	28 679 970-93 0010
	Brushed Dark Platinum	28 679 970-99 0010

Required miscellaneous



Concealed wall elbow - 35 085 970-90
 •min. recess depth 90 mm 0010
 •max. recess depth 163 mm

28 679 970 Product version from 3/13/2017

mm [inches]

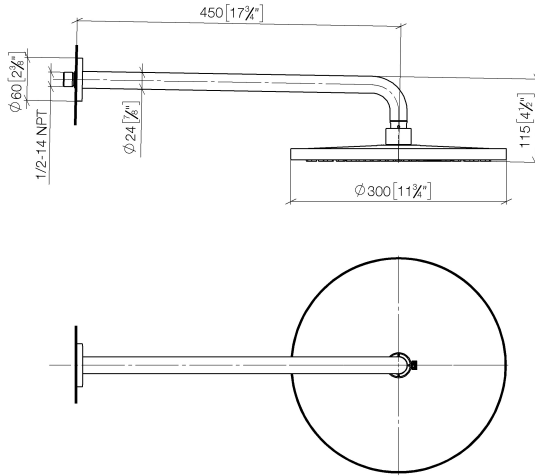

Codes & Standards

ASME A112.18.1	California Energy Commission (CEC)	cUPC	EPA WaterSense
----------------	------------------------------------	------	----------------

WaterSense



Certificates and sustainability

IAPMO_4976	IAPMO_11777
------------	-------------

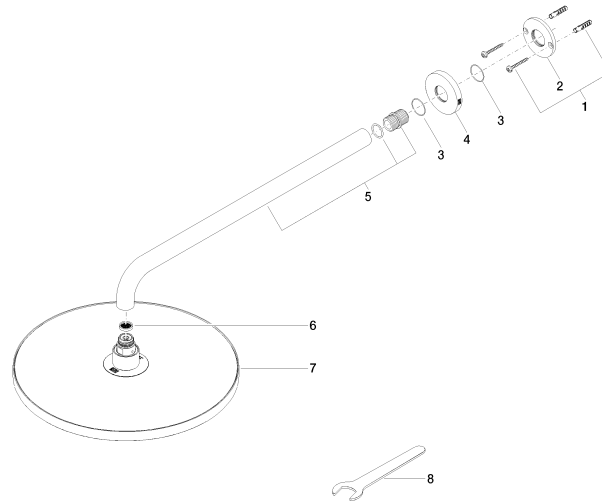

Spare parts list

No.	Item Number	Name	Quantity used	Delivery time
4	09 27 97 015-46	Rosette DB logo Ø 60 x 9 mm - Brushed Champagne (22kt Gold)	1.00	30
3	09 14 10 150 90	O-Ring 23 x 1,5 mm -	2.00	2
7	04 12 05 091 10-46	Rain shower round Ø 300 mm - Brushed Champagne (22kt Gold)	1.00	30
5	90 11 03 070 00-46	Pipe 462 x 61 x 24 mm - Brushed Champagne (22kt Gold)	1.00	30
8	90 30 09 069 00 90	Spanner -	1.00	2
2	09 17 20 120 90	Connection Ø 56,50 x 5 mm -	1.00	2
1	04 30 31 032 00 90	Attachment set Bolt 4 x 35 mm -	1.00	2
6	09 23 01 075 90	Sieve seal Ø 18 x 3,5 mm -	1.00	2