

**DuraStyle Wall Mounted Toilet # 2537590092**

| < 14 3/4 " > |

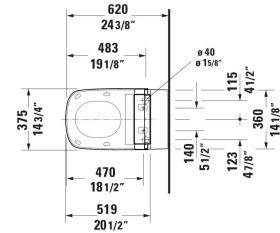
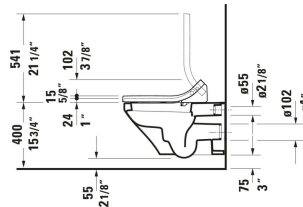
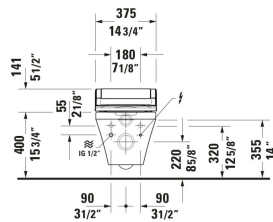

Wall Mounted Toilet	Dimension	Weight	Order number
Flush water quantity: 1.2/0.8 gal, Washdown model, Flushing rim: Closed, Outlet horizontal, Concealed fixation, Includes connecting set for SensoWash, cUPC listed: Yes			
<b>Colors</b>			
00 White			
<b>Variant</b>			
White High Gloss, Flush water quantity: 1.28/0.8 gal, WaterSense: Yes, ADA: Yes	14 3/4 "x14 "	67.902 lb	2537590092
<b>Spare parts</b>			
Installation Set	5 3/8 x 4 1/8 "	0.948 lb	005072
Noise reduction gasket	16 1/2 x 15 3/8 "	0.441 lb	005090
Actuator Plate A1 Plastic, Dual Flush, Trip lever type: Mechanical, Flush operation technology: Manual, Installation Type: surface mounted, Includes mounting frame, including mounting kit, Includes push rod	8 1/2 x 3/8 "	0.69 lb	WD5008
Connection Set Shower-toilets	8 5/8 x 10 1/4 "	1.543 lb	100691
<b>Suitable products</b>			
Shower toilet seat Matches series DuraStyle, White, Slow close, Seat material type: Duroplast, Lid material type: Duroplast, Water position adjustment: 5 Steps, Number of spray intensity options: 3 Steps, Number of spray temperature options: 4 Steps, Water position adjustment: 5 Steps, Rearwash, Frontwash, Pulsing shower spray: Oscillating, Operation type: Remote control, Controller, Self-cleaning function, Decalcification function, Holiday mode, Night light, cUPC listed: No, UL: No, 14 3/4 x 21 1/4 "	14 3/4 x 21 1/4 "		611200
In-Wall Tank & Carrier Standard Includes HDPE toilet wall-mounted outlet bend DN 90/90, Powder-coated, Installation Type: In lightweight stand construction, Installation Type: Drywall, Max. projection toilet: 24 5/8 ", Adjustable height: 9 1/2 ", Trip lever type: Mechanical, Trip lever placement: Front, Adjustable flush volumes, Flush type: Dual Flush, Insulated tank, Self-supporting, Suitable for panelling with plasterboards, 23 1/4 x 3 1/2 "	23 1/4 x 3 1/2 "		WD1022

**DuraStyle Wall Mounted Toilet # 2537590092**

|< 14 3/4 " >|

<p>Shower toilet seat Matches series DuraStyle, Slow close,          Number of warm air dryer options: 4 Steps, Water position          adjustment: 5 Steps, Number of spray intensity options: 3 Steps,          Number of spray temperature options: 4 Steps, Water position          adjustment: 5 Steps, Rearwash, Frontwash, Pulsing shower          spray: Oscillating, Warm air dryer, Number of user profiles: 4,          Self-cleaning function, Decalcification function, Energy saving          mode: Adjustable, Holiday mode, Night light, 14 3/4 x 20 1/2 "</p>	<p>14 3/4 x 20 1/2 "</p>	<p>613200</p>
--	--------------------------	---------------

*All drawings contain the necessary measurements which are subject to standard tolerances. They are stated in inch & mm and are non-binding. Exact measurements, in particular for customized installation scenarios, can only be taken from the finished ceramic piece.*

**SensoWash® Slim Shower toilet seat # 611200001001300 / 611200001501300**

| < 14 3/4 " > |

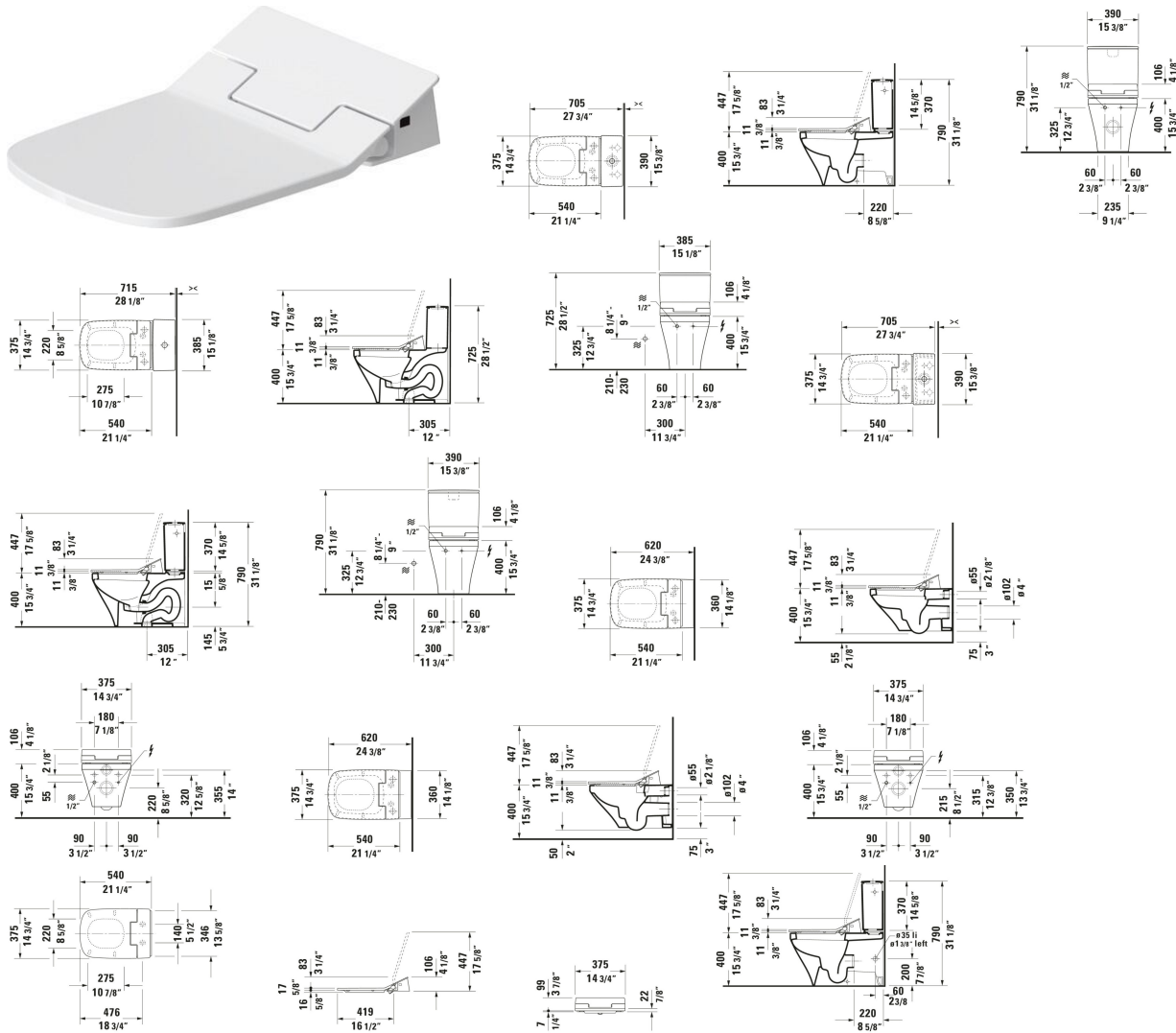

Shower toilet seat	Dimension	Weight	Order number
Matches series DuraStyle, White, Slow close, Seat material type: Duroplast, Lid material type: Duroplast, Lid actuation: Manual, Water position adjustment: 5 Steps, Number of spray intensity options: 3 Steps, Number of spray temperature options: 4 Steps, Water position adjustment: 5 Steps, Rearwash, Frontwash, Pulsing shower spray: Oscillating, Operation type: Remote control, Controller, Self-cleaning function, Holiday mode, Night light, cUPC listed: No, UL: No			
<b>Colors</b>			
00 White			
<b>Variant</b>			

**SensoWash® Slim Shower toilet seat # 611200001001300 / 611200001501300**

|< 14 3/4 " >|

Decalcification function, Connection voltage: 100 - 120 V, Min. frequency: 50 Hz, WaterSense: No, cUPC listed: Yes	14 3/4 "x4 1/8 "	12.125 lb	611200001001300
Seat material type: Thermoplastic, Lid material type: Thermoplastic, Heated seat, Decalcification function, Energy saving mode: Adjustable, Connection voltage: 100 - 120 V, Min. frequency: 50 Hz, WaterSense: No, cUPC listed: Yes	14 3/4 "x4 1/8 "	13.117 lb	611200001501300
<b>Installation accessories</b>			
Installation Set	4 1/8 x 5 3/8 "	0.948 lb	005072
Connection Set Shower-toilets	8 5/8 x 10 1/4 "	1.543 lb	100691
<b>Suitable products</b>			
One Piece Toilet SensoWash toilet, 28 1/8 ", elongated, Siphonic, Flushing rim: Closed, Outlet: vertical, Rough-in: 12 ", cUPC listed: Yes, 15 1/8 x 28 1/8 "	15 1/8 x 28 1/8 "		215751
Wall Mounted Toilet Flush water quantity: 0.8 gal, Washdown model, Flushing rim: Closed, Outlet horizontal, Concealed fixation, Includes connecting set for SensoWash, cUPC listed: Yes, 14 3/4 x 24 3/8 "	14 3/4 x 24 3/8 "		253759
Toilet Bowl SensoWash toilet, 27 3/4 ", elongated, Flush water quantity: 1.28/1.28 gal, Siphonic, Flushing rim: Closed, Trip lever placement: Top, Outlet vertical, cUPC listed: Yes, 15 3/8 x 27 3/4 "	15 3/8 x 27 3/4 "		216051

*All drawings contain the necessary measurements which are subject to standard tolerances. They are stated in inch & mm and are non-binding. Exact measurements, in particular for customized installation scenarios, can only be taken from the finished ceramic piece.*