

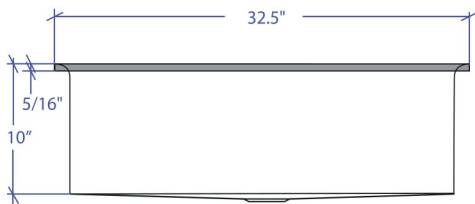

*Flush-Mount Installation Kit is included with each sink
 *Custom ADA compliant versions are available

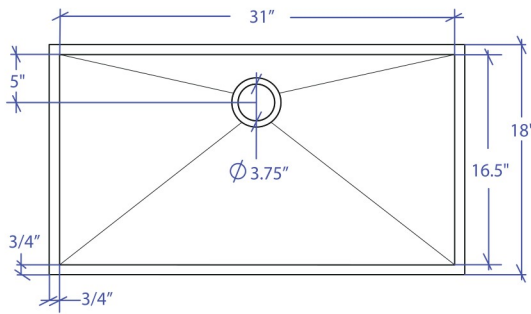

• FEATURES

- 16-gauge type 304 stainless steel
- Stainless steel rim support tubing
- 1/4" round profile rim and basin design

• TECHNICAL INFORMATION

- External dimension: 32.5"Lx18"Wx10"D
- Basin dimensions: 31"Lx16.5"Wx10"D
- Rim width: 3/4"
- Rim thickness: 5/16"

• FINISHES

- Rose Gold PVD satin brushed stainless steel

• INSTALLATION OPTIONS

- Flush-mount

• MINIMUM CABINET SIZE (I.D.)

- Flush-mount 35.5"

• INDUSTRY'S ONLY STAINLESS STEEL SINK DESIGNED SPECIFICALLY TO BE FLUSH-MOUNTED

• INTERNATIONAL PATENT PENDING

• FLUSH-MOUNT INSTALLATION

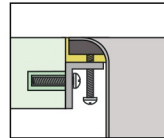

Flush-mount

• ACCESSORIES OPTIONS

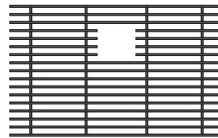

MBG-6514RGSB
Basin Grid

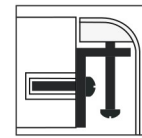

Flush Mount Kit
(Included)
MTK-613AL



MCB-651BB
Cutting Board

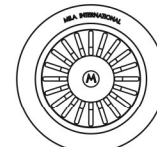

MKD-101RGSB
Strainer

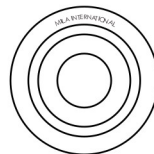

MDC-101RGSB
Disposal Collar

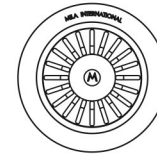

MDC-102RGSB
Disposal Collar

PROJECT INFORMATION

Project			
Date	/	/	QTY
Specifier			
Contact			
Note			