

Geberit Duofix element for wall-hung WC, 120 cm, with Sigma concealed cistern 12 cm, for wood frame wall

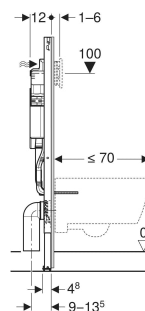
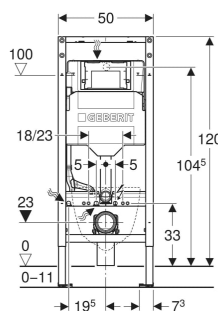

APPLICATION PURPOSES

- For metal and wood frame walls
- For Geberit Duofix system walls
- For installation in part- or room-height prewalls
- For installation in room-height partition walls
- For floor constructions 0–11 cm
- For wall-hung WCs

CHARACTERISTICS

- 2025 range
- Statically self-supporting frame, protected against corrosion with powder coating
- Frame fulfils standard requirements in accordance with ASME A112.6.2, ANSI Z124.4
- Frame for wall-hung WCs with connection dimensions as per EN 33 and projection up to 70 cm
- Frame with $\varnothing 9$ mm drilling holes for fastening in wood frame construction
- Alternative fastening point for wall anchors
- Rotating foot plates, suitable for installation in U profiles UW 50 and UW 75
- Foot plates that can be mounted in Geberit Duofix system rail without tools, without additional components
- Galvanised non-slip leg supports protected against corrosion

- Connection bend can be mounted without tools at different depths, adjustable range 45 mm
- Geberit Sigma concealed cistern 12 cm, fully insulated against condensation
- Cistern fulfils standard requirements in accordance with ASME A112.6.2 and ANSI Z124.4
- Flush valve fulfils standard requirements in accordance with CSA B125.3, ASME A112.19.5, IAPMO PS-50, ASME A112.19.2 in connection with ceramic appliance listed
- Fill valve fulfils standard requirements in accordance with ASSE 1002, CSA B125.3
- For front actuation, suitable for single, dual and stop-and-go flushes
- Immediate post flush possible with factory setting
- Tool-free installation and maintenance work on concealed cistern
- Water supply connection on the rear or top centre
- Protection box for service opening, can be cut to length, protects against moisture and dirt
- With conduit pipe for feed pipe for Geberit AquaClean shower toilets and for connection cable
- Fastening for electrical connection and Power & Connect Box

TECHNICAL DATA

Flow pressure 10–1000 kPa

Water temperature max.	25 °C
Flush volume, factory setting	6 / 3 l
Flush volume large, adjustment range	4 / 4.5 / 6 / 7.5 l
Flush volume small, adjustment range	2–4 l
Flow rate at 300 kPa / 3 bar	0.16 l/s
Minimum flow pressure	10 kPa
Calculated flow rate	0.09 l/s
Product material	Steel
Height-adjustable	Yes

SCOPE OF DELIVERY

- Water supply connection R 1/2", compatible with MasterFix and MeplaFix, with integrated angle stop valve and hand wheel
- Elbow tap connector 90°
- Protection box for service opening
- Connection set for WC, $\varnothing 90$ mm
- Connection bend 90° made of PE-HD, $\varnothing 90$ mm
- Adapter socket $\varnothing 90$ mm / 3"
- Fastening and protection material

ACCESSORIES

- Geberit sound insulation set for wall-hung WC

- Geberit Duofix fastening material for stud clearance 50–57.5 cm
- Geberit set of support brackets for WC ceramic appliances with small contact surfaces
- Geberit Duofix set of wall anchors for single installation
- Geberit Duofix set of wall anchors for single installation, corner construction
- Geberit Duofix set of wall anchor extensions
- Geberit Duofix set of foot fastener on rear wall

Art. no.	B cm	H cm	T cm
111.335.00.7	50	120	12