

# IHX60-UAS-32189-G

**Undermount apronfront stainless steel sink**

**Handcrafted**

Slightly rounded corners [0,60"]

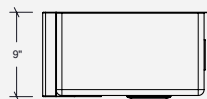
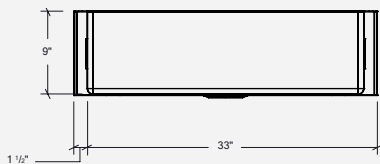
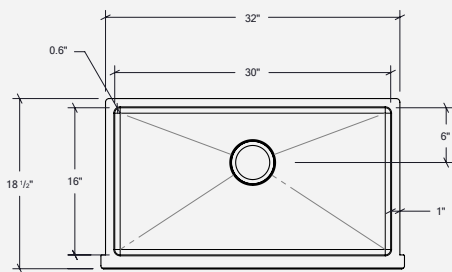
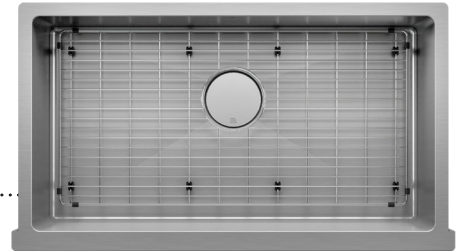

**Installation**

Undermount with apronfront

**Bowl**

30" x 16" x 9"

**Overall**

33" x 18" x 9"

**Recommended cabinet**

36"

**Drain**

Ø 3 1/2"

**Features**

- 304 brushed finish stainless steel (18/10) – 18 gauge
- Sound deadening pads for maximum noise reduction
- Drain located towards rear providing more space under the sink
- Undermount installation hardware included
- Product certified ASME A112.19.3, CSA B45.4-2022
- Can be installed farmhouse undermount overhang 1/8" or farmhouse undermount reveal 1/2"

**Included**

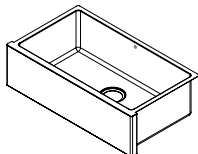

Sink

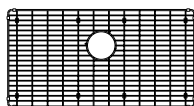

Grid

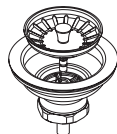

Drain with tailpiece



Installation hardware

**Warranty**

JULIEN offers a LIMITED LIFETIME WARRANTY on its stainless steel sinks against defects of material and workmanship. For further details on our product warranty, please refer to our catalog or web site.