

**Duravit No.1 Bathtub # 700697000000090**

| < 60 " > |

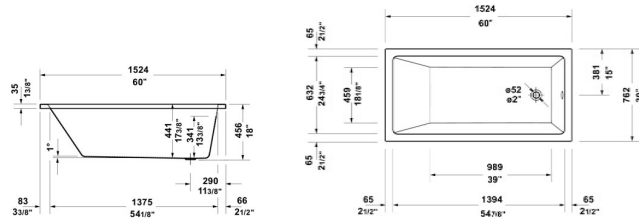

Bathtub	Dimension	Weight	Order number
Rectangular, Installation Type: drop-in, Installation Type: Undermount installation, White, Material: Sanitary acrylic, Number of backrests: 1 Variable, Overflow: Yes, Drain orientation: Foot end, Overflow position: Foot end, Capacity gal: 39 gal			
<b>Colors</b>			
00 White			
<b>Variant</b>			
Seamless acrylic panel	60 "x16 1/2 "	57.982 lb	700697000000090
<b>Suitable products</b>			
Waste and overflow Bowden cable length: 22 1/8 ", 28 3/4 x 3 1/2 "	28 3/4 x 3 1/2 "		792824
Waste and overflow Bowden cable length: 34 ", 25 5/8 x 3 1/2 "	25 5/8 x 3 1/2 "		792821
shower tray foot Matches series Architec, 2 1/8 x 2 1/8 "	2 1/8 x 2 1/8 "		790164

All drawings contain the necessary measurements which are subject to standard tolerances. They are stated in inch & mm and are non-binding. Exact measurements, in particular for customized installation scenarios, can only be taken from the finished ceramic piece.