

ARAMINTA UNDERMOUNT BASIN

Cat. No.
4-145WH



Drain not provided

W: 20-⁷/₈"
D: 14-¹/₂"
H: 8-³/₈"

Features:

- ▶ Made of Vitreous China
- ▶ Pre-drilled overflow hole
- ▶ Designed for undermount installation
- ▶ Sink Clips Needed (Order Separately)
- ▶ For use with grid drain #5600 or #57080
- ▶ Drain not included
- ▶ Template included

Colors:

WH White

Compliance Certification

Meets or exceeds the following specifications: ASME 12.19.2.2018 for vitreous china fixtures.

Interior Dimensions:

Basin Interior: 12-¹/₄" x 18-⁵/₈"
Basin Depth: 6-¹/₄"
Water depth to overflow: 5-¹/₈"
Drain: 1-³/₄"

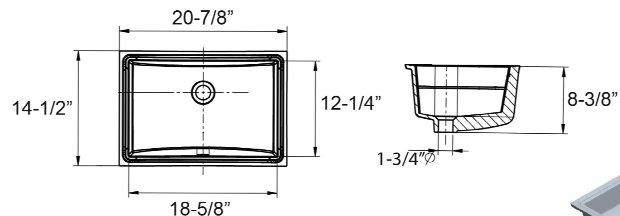

Dimensions of fixture are nominal and may vary within the range of tolerances established by ANSI Standard A112.19.2.2018. Dimensions and specifications subject to change without notice.