

Karree Toothbrush Holder # 0099511000

|< 3 7/8 " >|

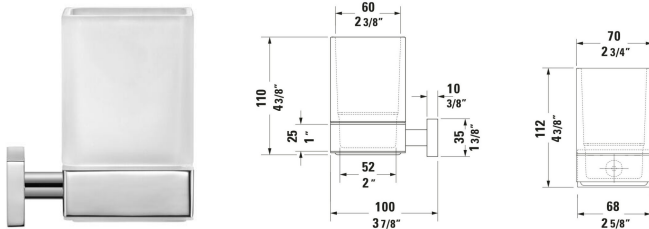

Toothbrush Holder	Dimension	Weight	Order number
Chrome, Installation Type: Wall-mounted			
Colors			
10 Chrome			
Variant			
Accent color: White Matte, Material: GlassBrass, Position toothbrush holder: Middle	3 7/8 "x4 3/8 "	1.764 lb	0099511000

All drawings contain the necessary measurements which are subject to standard tolerances. They are stated in inch & mm and are non-binding. Exact measurements, in particular for customized installation scenarios, can only be taken from the finished ceramic piece.